

## wiper A62-A

## seal spec



### description

A62-A are polyurethane manufactured lipped wipers with integrated metal reinforcement for open groove assembly. these are typically used in severe applications where there is abrasion due to solid matter on rod surface.

### application



not bolded symbols; please consult our technical for application limitations

### category of profile

molded/standard/trade product or machined with minor design change.

### single acting

### area of application: hydraulics

due to their outstanding wiping capacities SWP scrapers are recommended wherever there are dusty and humid conditions and especially for the following applications:

- mobile hydraulic machinery.
- construction machinery.
- link pin seals.
- lift trucks.
- truck cargo cranes.
- agriculture machinery.

### advantages

- space-saving construction.
- simple small installation groove.
- firm fit in the groove due to metallic press fit.
- at regreasing of drag bearing, the scraper lip opens at low overpressure; old grease can escape.
- high wear resistance.

### operating parameters & material

material		temperature	running surface speed
wiping part	housing		
PU 92 shore A	metal (unalloyed steel DIN 1624)	-35 °C ... +100 °C	1 m/s

the stated operation conditions represent general indications. it is recommended not to use all maximum values simultaneously. surface speed limits apply only to the presence of adequate lubrication film.

**surface quality**

surface roughness	material	Rtmax (µm)	Ra (µm)
mating surface	PTFE + .....	0.63 - 2.50	0.05 - 0.20
	PU & Rubber	1.00 - 4.00	0.10 - 0.40
groove surface		< 16	< 1.6

**tolerance recommendation****seal housing tolerances**

ØD	H8
----	----

**fitting & installation**

the wiper is easily built in to split housing, provided the lead-in chamfer is in accordance with the table below:

H [mm]	chamfer [mm] with angle 20°
≤ 4,5	0,6
5	0,6
6	0,8
7	0,8
8	1
9	1
10	1,4
12	1,8
14	2
16	2,4

**seal & housing recommendations**

please note that we are able to produce those profiles to your specific need or any non standard housing. for detail measurements, please see seal-mart catalog...

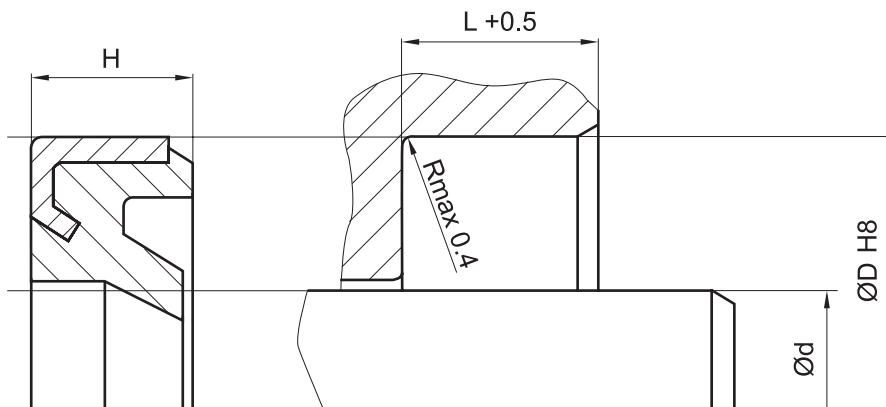



**fitted:**

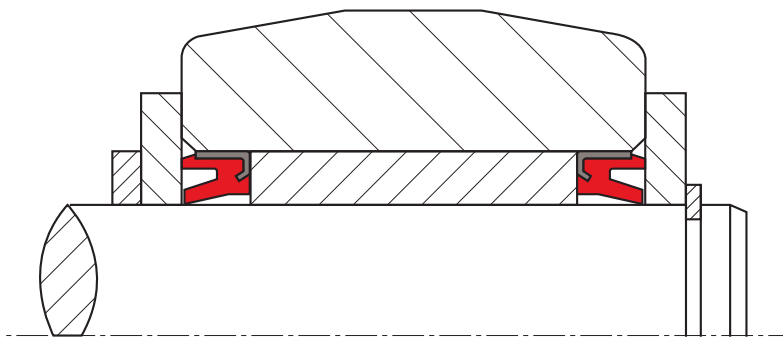

link pin seal

*don't hesitate to contact our technical department for further information or for special requirements (temperature, speed etc.), so that suitable materials and/or designs can be recommended.*